

THIS DRAWING IS TO BE USED ONLY FOR THE PURPOSE OF ISSUE THAT IT WAS ISSUED FOR AND IS SUBJECT TO AMENDMENT.
EXCEPTIONAL RISKS RELATING TO THE WORKS ASSOCIATED WITH THIS DRAWING ARE IDENTIFIED BELOW.

CONSTRUCTION
RISK: XXX

NOTES
Event Date:
2022

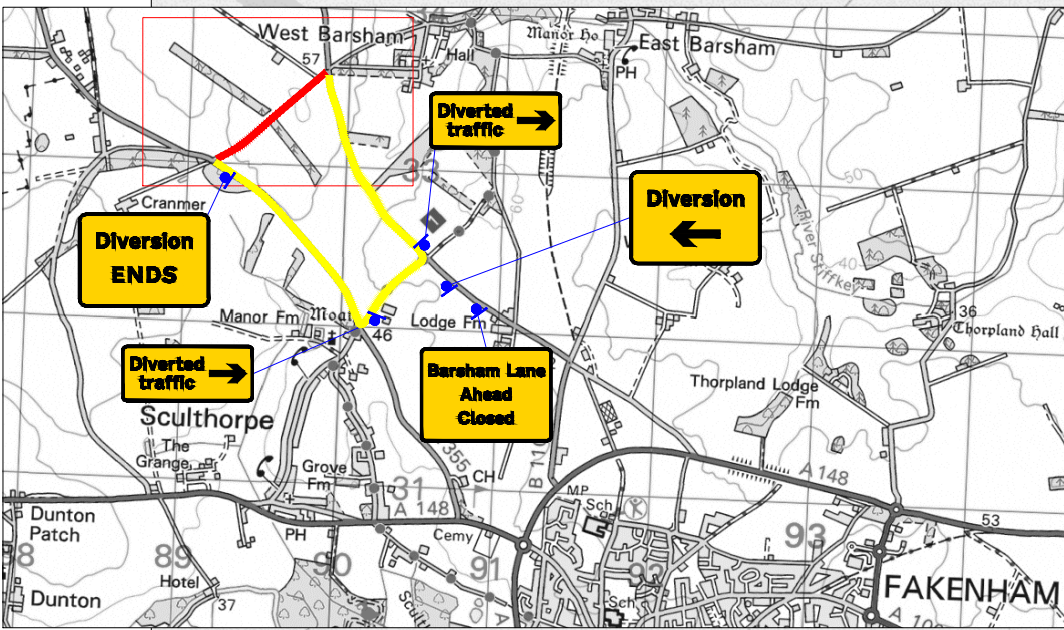
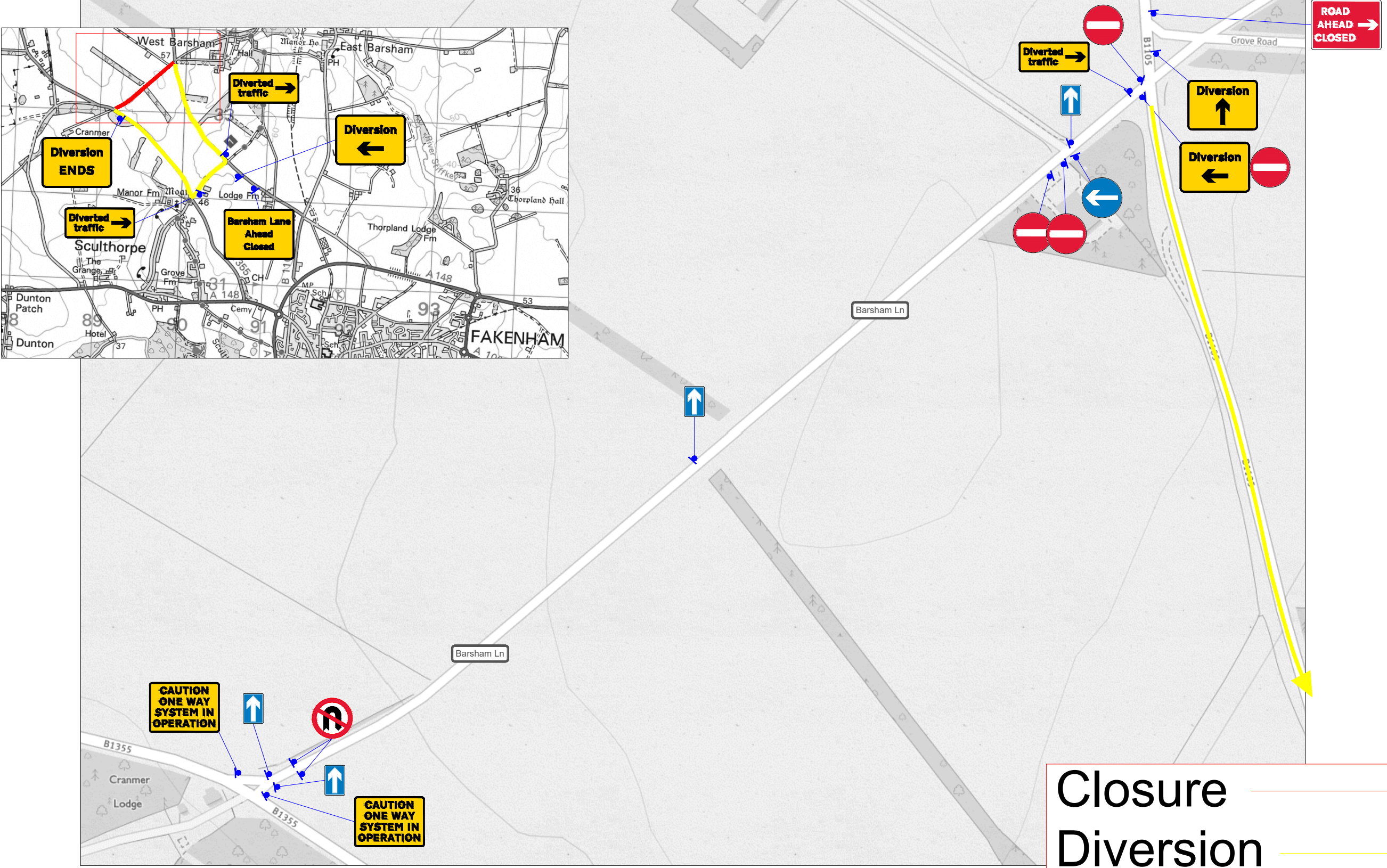

Closure ———
Diversion —————▶

REVISION DETAILS			
By	Check	Date	Suffix

Purpose of issue: **DRAFT**

CHEVRON
A WORK-ZONE SAFETY COMPANY

Chevron
3 Thame Business Park
Wenman Road
Thame
OX9 3XA
Tel: 01844 354666 www.chevrontrm.com

Project Title: **Outlaw Half at Holkham**
Plan 17 of 18

Drawing Title: **Holkham Hall**
Wells Next the Sea
Norfolk
NR23 1AB

Designed: DA	Drawn: MH	Checked: DA	Approved: DA	Date: 19-04-2022
Internal Project No: PSXXXXX	Subsidiary: -			
Scale @ A3: 1:	Volume: TRAFFIC_MANAGEMENT			

THIS DOCUMENT HAS BEEN PREPARED PURSUANT TO AND SUBJECT TO THE TERMS OF CHEVRON'S APPOINTMENT BY ITS CLIENT. CHEVRON ACCEPTS NO LIABILITY FOR ANY USE OF THIS DOCUMENT OTHER THAN BY ITS ORIGINAL CLIENT OR FOLLOWING CHEVRON'S EXPRESS AGREEMENT TO SUCH USE. AND ONLY FOR THE PURPOSES FOR WHICH IT WAS PREPARED AND PROVIDED.

Drawing Number: HE000000	Project Code/PIN: CHEV	Originator: TTM	Volume: DR	Number: X 0001	Rev: Xxx
Location:	Type:	Role:	Number:		